

## Using Retractable Sun Visor

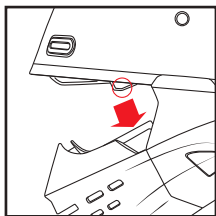

To lower the sunvisor, simply pull the sunvisor lever down.

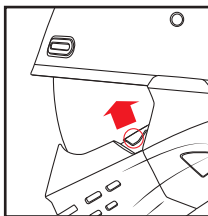

To raise the sunvisor, simply push the sunvisor lever up.

## Removing Sun Visor

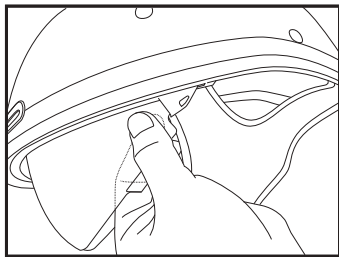

Firmly hold the sun visor with your hand and gently pull one side out away from the helmet to release.

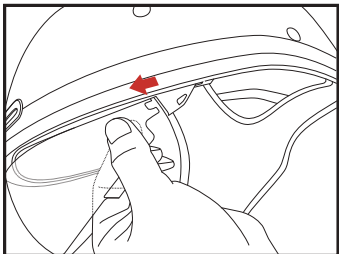

Repeat to release the opposite side.

Reverse process for installation.

## Installing Removable Mask

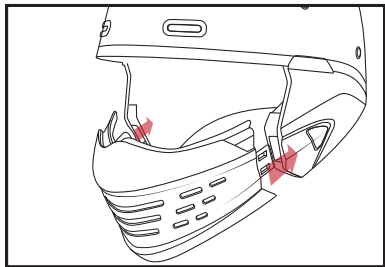

Push the mask into two holes in front of the sleeve until you hear “click” sound. Be sure to hear this “click” sound to secure the mask.

Then pull the mask to outer direction several times to check whether it is securely assembled to the helmet.

## Removing The Mask

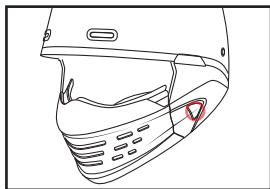

Push the button (in red circle) on one side of the sleeve.

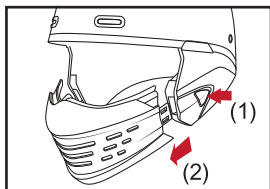

While pushing the button completely with one hand, pull out the mask with the other hand, then do the same for the other side of the sleeve.

### **WARNING**



The removable mask provides weather protection but NOT impact protection.

## Removing Comfort Sleeve

- ① Remove the mask. Then remove the cheek pads/neck roll from the comfort sleeve.

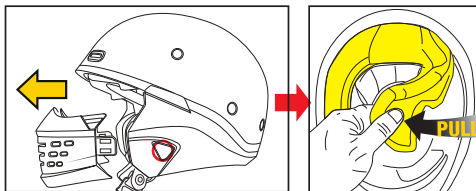

- ② Unlock the comfort sleeve release lever. See images below.

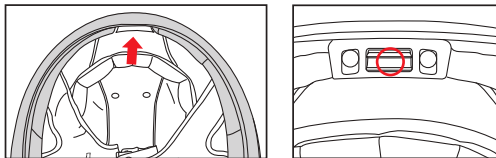

Push the release lever on the rear section of the comfort sleeve

- ③ Remove the comfort sleeve. See images below.

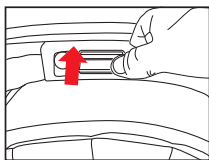

Push the release lever on the rear section of the comfort sleeve

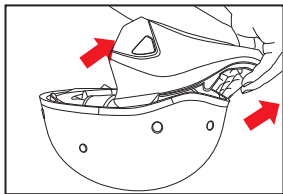

Unlatch the release lever with one hand. Grab the back of the comfort sleeve using your other hand and pull out diagonally.

## Assembling Comfort Sleeve

- 1 Locate gap of the comfort sleeve in position.

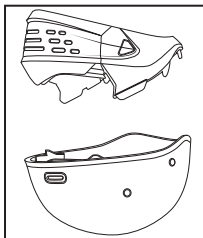
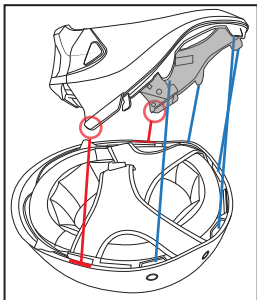

Check the gap of the comfort sleeve (Red Circle).

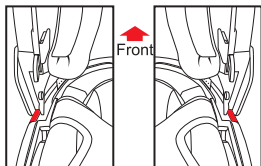

Locate the gap of the comfort sleeve on the frame that near the end of the sun visor (if the comfort sleeve won't fit, you can stretch the comfort sleeve out a little bit).

- 2 Assemble the comfort sleeve in outer shell.

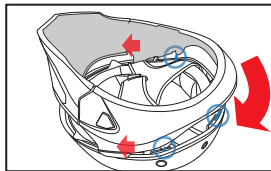

While the edge of the comfort sleeve are moving forward on the frame, assemble the rear section of the comfort sleeve to the outer shell.

Check the blue lines and circles in the picture above.

### **WARNING**

This is basically a half face helmet so there is no impact protection at or below the ears because there is no EPS liner at or below the ears.

The comfort sleeve provides weather protection but NOT impact protection.

## Removing Crown Liner

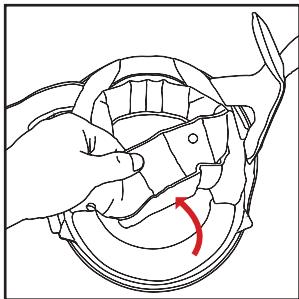

After removing the mask, you can remove the crown liner.

Detach 4 snaps in front and back of the crown liner, then pull it off from the helmet.

Reverse the process to install it again.

It is easier to remove also the comfort sleeve before removing the crown liner.

## Removing Neck Roll & Cheek Pad

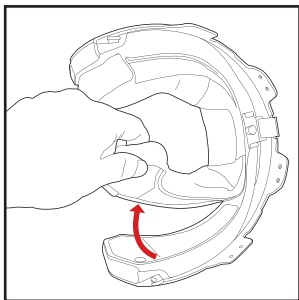

Pull it off by detaching 6 velcro points around it.

Reverse the process to install it again.

You can do it easier after removing the comfort sleeve.

### **⚠ WARNING**

Small neodymium magnets are used for easier operation. The magnet force is not very strong, and generally each magnet size is not considered as dangerous.



However, consult your physician before using if you are a pacemaker wearer and not sure about the effect caused by these magnets.

## Securing and Wearing Your Helmet

Do not simply pull your helmet down onto your head like a hat. Your helmet should be worn as follows: Using both hands grab the helmet's bottom rim while holding the chin straps with your thumbs. Then "roll" the helmet onto your head starting at the forehead. Continue rolling the helmet on towards the back of the head until it comes to rest with your head fully in contact with the inner lining and cheek pads.

## How to Use Chinstrap

### Double D-Ring

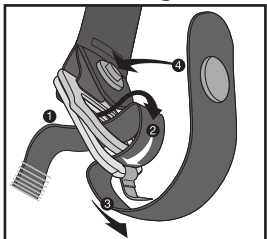

1. Lead chinstrap through eyelets of both rings.
2. Curl back and thread through taller ring with nylon pull-tab.
3. Securely tighten strap until comfortable and safe.
4. Press and snap buttons together to manage excess strap.

### **⚠ WARNING**

- Firmly and securely fasten your chinstrap.
- Check your chinstrap for tightness occasionally as vibration or wind may loosen it.