



INSTRUCTIONS

-J04712

REV. 2008-05-28

PUSHBUTTON FUEL CONSOLE DOOR RELEASE

GENERAL

Kit Number

53919-04A

Models

For model fitment information, see the P&A Retail Catalog or the Parts and Accessories section of www.harley-davidson.com (English only).

Kit Contents

See Figure 1 and Table 1.

INSTALLATION

1. Open the fuel door. Remove and discard stock lock and nut.
2. See Figure 1. Install pushbutton lock (2) and nut (1) on fuel door.
3. Remove screws (A) and replace the stock hinge mounting clip with the hinge mounting clip (3) from the kit. Install stock screws. Do not over-tighten.
4. Close the fuel door. A small amount pressure will be needed to close the fuel door because it is now spring-loaded.

NOTE

To keep the pushbutton lock assembly operating smoothly, lightly spray lubricant on the mechanism as needed.

SERVICE PARTS

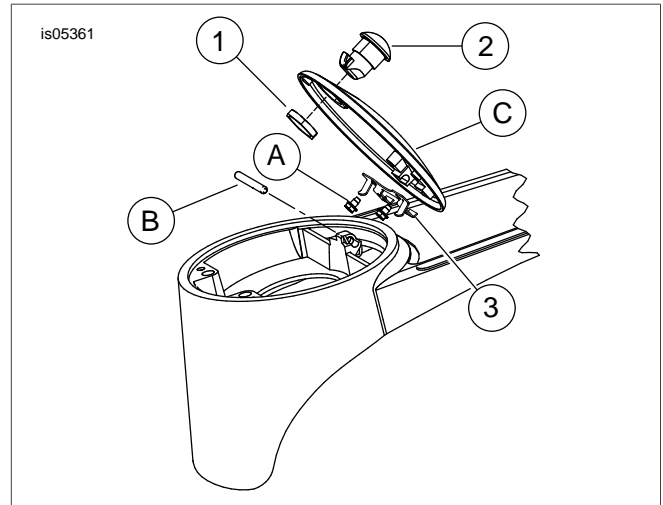

Figure 1. Service Parts: Console Pushbutton Fuel Door Release

Table 1. Service Parts

Item	Description (Quantity)	Part Number
1	Nut, hex	84850-92
2	Fuel release, pushbutton	Not Sold Separately
3	Clip, hinge mounting	10334
Items mentioned in text, but not included in kit.		
A	Screw (2)	
B	Hinge pin	
C	Fuel door	