



INSTRUCTIONS

-J04469

REV. 2008-02-11

STEERING HEAD WASHER KIT

GENERAL

Kit Number

45740-07

Models

All 2006-2007 Dyna and 2008 and earlier FXDWG Models
All 2008 and earlier FX Softails (except FX Springer Models)

Kit Contents

Table 1. Kit Contents

Item	Description (Quantity)	Part Number
1	Washer, hardened	45727-08

INSTALLATION

WARNING

The rider's safety depends upon the correct installation of this kit. Use the appropriate service manual procedures. If the procedure is not within your capabilities or you do not have the correct tools, have a Harley-Davidson dealer perform the installation. Improper installation of this kit could result in death or serious injury. (00333a)

NOTE

This instruction sheet references Service Manual information. A Service Manual for your model motorcycle is required for this installation and is available from a Harley-Davidson Dealer.

1. See Figure 1. Remove the fork stem cap (1). Bend the lockwasher (2) tab away from the steering stem nut (3) and remove the fork stem nut and lockwasher. Discard the lockwasher.

NOTE

Always tighten the steering stem nut (3) to 70 - 80 ft-lbs (95 - 109 Nm) before measuring fall away. Lubricate threads of nut with a **small** amount of clean engine oil. Avoid applying oil to the mating surfaces of the steering stem nut (3) and the new hardened washer from the kit.

2. Install the new hardened washer from the kit (2) and steering stem nut (3). Tighten steering stem nut (3) to 70 - 80 ft-lbs (95 - 109 Nm).
3. Check fall away following the instructions in STEERING HEAD BEARINGS BEARING ADJUSTMENT (FALL-AWAY) in an appropriate Service Manual, **however, tighten the steering stem nut (3) to 70 - 80 ft-lbs**. Adjust adjusting nut (5), if necessary per instructions.
4. Install fork stem cap (1).

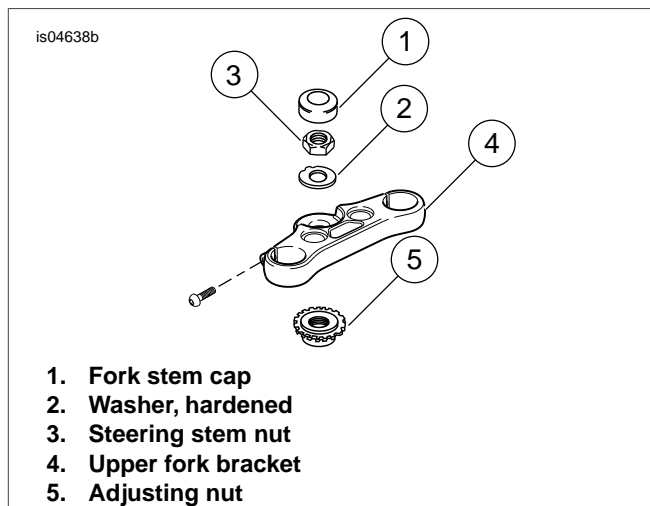

Figure 1. Front Fork Assembly (FXD Triple Tree Shown)