



INSTRUCTIONS

-J04220

REV. 2008-05-06

REAR TYPHOON WHEELS

GENERAL

Kit Number

44617-08, 44685-08, 40884-08, 44649-08

Models

For model fitment information, please see the P&A Retail Catalog or the Parts and Accessories section of www.harley-davidson.com (English only).

Additional Parts Required

These kits include the custom wheel only.

Proper installation of these kits require the separate purchase of the following parts which are available at a Harley-Davidson dealer.

- Wheel Bearing Remover and Installer (HD-44060-A)
- Wheel Installation Kit (See tables for part number)

The following Harley-Davidson Genuine Motor Accessories are recommended for proper maintenance and cleaning:

- Harley® Bright™ Chrome Cleaner (94683-99)
- Harley® Glaze™ Polish and Sealant (99701-84)
- Harley® Wheel and Spoke Brush (43078-99)
- Harley-Davidson® Wheel and Tire Cleaner (94658-98)

Touch-up paint for painted wheels is available from a Harley-Davidson dealer:

- Touch-Up pen, wheel, black (94482)

WARNING

The rider's safety depends upon the correct installation of this kit. Use the appropriate service manual procedures. If the procedure is not within your capabilities or you do not have the correct tools, have a Harley-Davidson dealer perform the installation. Improper installation of this kit could result in death or serious injury. (00333a)

NOTE

This instruction sheet references service manual information. A service manual for your model motorcycle is required for this installation and is available from a Harley-Davidson dealer.

Kit Contents

See Figure 1 and Service Parts Tables.

INSTALLATION

1. Remove existing rear wheel assembly. Save axle, axle nut, brake disc, and wheel spacers for kit installation. Refer to REAR WHEEL in Service Manual.

NOTES

Prior to removing or installing the wheel, the rear brake caliper must be removed.

The cotter pin or spring clip for the axle nut must be replaced. They are available for purchase from a dealer. See a dealer for the correct part number for your model motorcycle.

Use plastic protectors on tire mounting tools and rim clamps when mounting a tire to a painted wheel.

For wide low profile tires a tire mounting machine with a second arm to press down on the sidewall while the wheel is rotating is recommended.

When mounting tires, liberally use tire lube on the wheel and tire.

For tire removal, use plastic inserts between the rim and tire after breaking the bead to create a large enough gap for the rim clamps.

CAUTION

Do not re-use brake disc screws. Re-using disc screws can result in torque loss and damage to rotor and/or brake assembly. (00319b)

CAUTION

Do not re-use sprocket mounting screws. Re-using sprocket mounting screws can result in torque loss and damage to the sprocket and/or belt assembly. (00480b)

2. See Figure 1. Install valve stem assembly (E) on wheel. Refer to TIRES in service manual.
3. Assemble wheel installation kit components, stock brake disc, and sprocket to wheel using the service parts table. Refer to REAR WHEEL in Service Manual.

NOTES

Install the primary bearing first using service manual and WHEEL BEARING REMOVER/INSTALLER.

The machined grooves in the hub face indicate the primary bearing side.

4. Install rear wheel (1), stock axle, and stock spacers to motorcycle. Refer to REAR WHEEL in service manual.

MAINTENANCE AND CLEANING

Chrome parts must be maintained regularly to keep their original shine and luster.

1. Clean heavily-soiled wheel surfaces using Harley-Davidson Wheel and Tire Cleaner, applied with Harley Wheel and Spoke Brush.
2. Thoroughly clean chrome with a good quality chrome cleaner, such as Harley Bright Chrome Cleaner.

3. After cleaning and polishing, seal the finish with a good quality sealer, such as Harley Glaze Polish and Sealant.

SERVICE PARTS

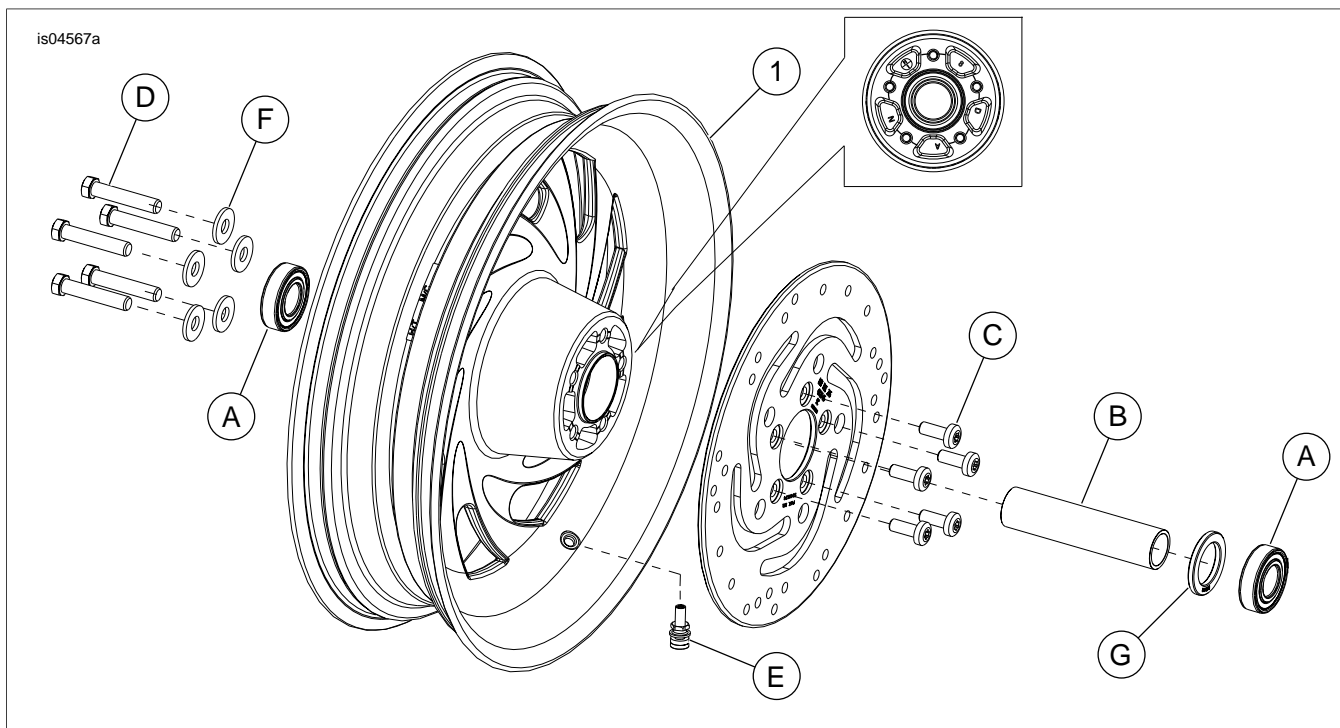

Figure 1. Service Parts: Rear Typhoon Wheels

Table 1. Service Parts Table

Kit	Installation Kit	Item	Description (Quantity)	Part Number	
40884-08, 44649-08		1	Wheel	Not Sold Separately	
		1A	Machined groove	Not Sold Separately	
		Items requiring separate purchase:			
2008 and later FXST, FXSTB, FXSTC	43878-08 Rear 17x6 inch Fitment	A	Bearing (2)	9276	
		B	Sleeve, bearing spacer	41696-08	
		C	Disc screw (5)	43567-92	
		D	Sprocket screw (5)	3109	
		E	Valve stem assembly (long)	43206-01	
		NOTE: Discard the following components which are provided with this installation kit, but are not required for this fitment.			
			Shim, bearing	43904-08	
			Sleeve, bearing spacer	41900-08	
			Sprocket screw (5)	3814	
			Sprocket screw (5)	3899	
	Valve stem assembly (short)	43157-83A			
	Washer (5)	6516HW			

Table 2. Service Parts Table

Kit	Installation Kit	Item	Description (Quantity)	Part Number	
44617-08, 44685-08		1	Wheel	Not Sold Separately	
		1A	Machined groove	Not Sold Separately	
		Items requiring separate purchase:			
2000-2007 FXSTD Models	43854-08 17x4.5 inch rear wheel	A	Bearing (2)	9267	
		B	Sleeve, bearing spacer	43608-00	
		C	Disc screw (5)	43567-92	
		D	Sprocket screw (5) (2006 and earlier models)	3737A	
			Sprocket screw (5) (2007 models)	3109	
		E	Valve stem assembly	43206-01	
		F	Washer (5) (2006 and earlier models)	6516HW	
		NOTE: Discard the following components which are provided with this installation kit, but are not required for this fitment.			
		Sleeve, bearing spacer			43618-06
		Sleeve, bearing spacer			43618-07
		Sprocket screw (5)			3899
		Valve stem assembly			43157-83A
		Use with 2006-2007 Dyna	43861-08 17x4.5 inch rear wheel	A	Bearing (2)
B	Sleeve, bearing spacer			43517-00	
C	Disc screw (5)			43567-92	
D	Sprocket screw (5) (2006 models)			3873	
	Sprocket screw (5) (2007 models)			3109	
E	Valve stem assembly (long)			43206-01	
F	Washer (5) (2006 models)			6516HW	
NOTE: Discard the following components which are provided with this installation kit, but are not required for this fitment.					
Sleeve, bearing spacer				43704-01	
Sprocket bolt (5)				40439-01	
Sprocket screw (5)				3737A	
Sprocket screw (5)				3899	
Sprocket washer (5)				7039	
TORX® bolt (5)			4552		
Valve stem assembly (short)			43157-83A		
Use with 2008 and later Dyna (except FXDF)	41451-08 17x4.5 inch rear wheel.	A	Bearing (2)	9276	
		B	Sleeve, bearing spacer	43905-08	
		C	Disc screw (5)	43567-92	
		D	Sprocket screw (5)	3109	
		E	Valve stem assembly (long)	43206-01	
		G	Shim, bearing (install under primary bearing)	43904-08	
		NOTE: Discard the following components which are provided with this installation kit, but are not required for this fitment.			
		Valve stem assembly (short)			43157-83A