



# INSTRUCTIONS

-J04148

REV. 2011-03-18

## XL SEAT KITS

### GENERAL

#### Kit Number

51736-07, 51737-07, 51738-07, 51739-07, 51747-07, 51749-07 and 52000024.

#### Models

For model fitment information, see the P&A Retail Catalog or the Parts and Accessories section of [www.harley-davidson.com](http://www.harley-davidson.com) (English only).

#### Additional Parts Required

- On models without passenger footpegs, install Passenger Footpeg Kit 50203-04.
- XL1200N, XL883N, and XL1200X models require separate purchase of guide washer 7487.

### WARNING

Do not install these seat kits on motorcycles that are not equipped with an appropriate grab strap and passenger footpegs. If footpegs and grab strap are not installed, passenger could fall from moving motorcycle or grab onto operator, causing loss of control and death or serious injury. (000410b)

#### Kit Contents

See Figure 3 and Table 1.

### NOTICE

Detach passenger seat strap before removing seat. Failure to do so can result in damage to rear fender paint. (00225a)

### REMOVAL

Remove the seat according to the directions given in the Owners Manual. Save the seat mounting screw (part number 2952A) to install the new seat.

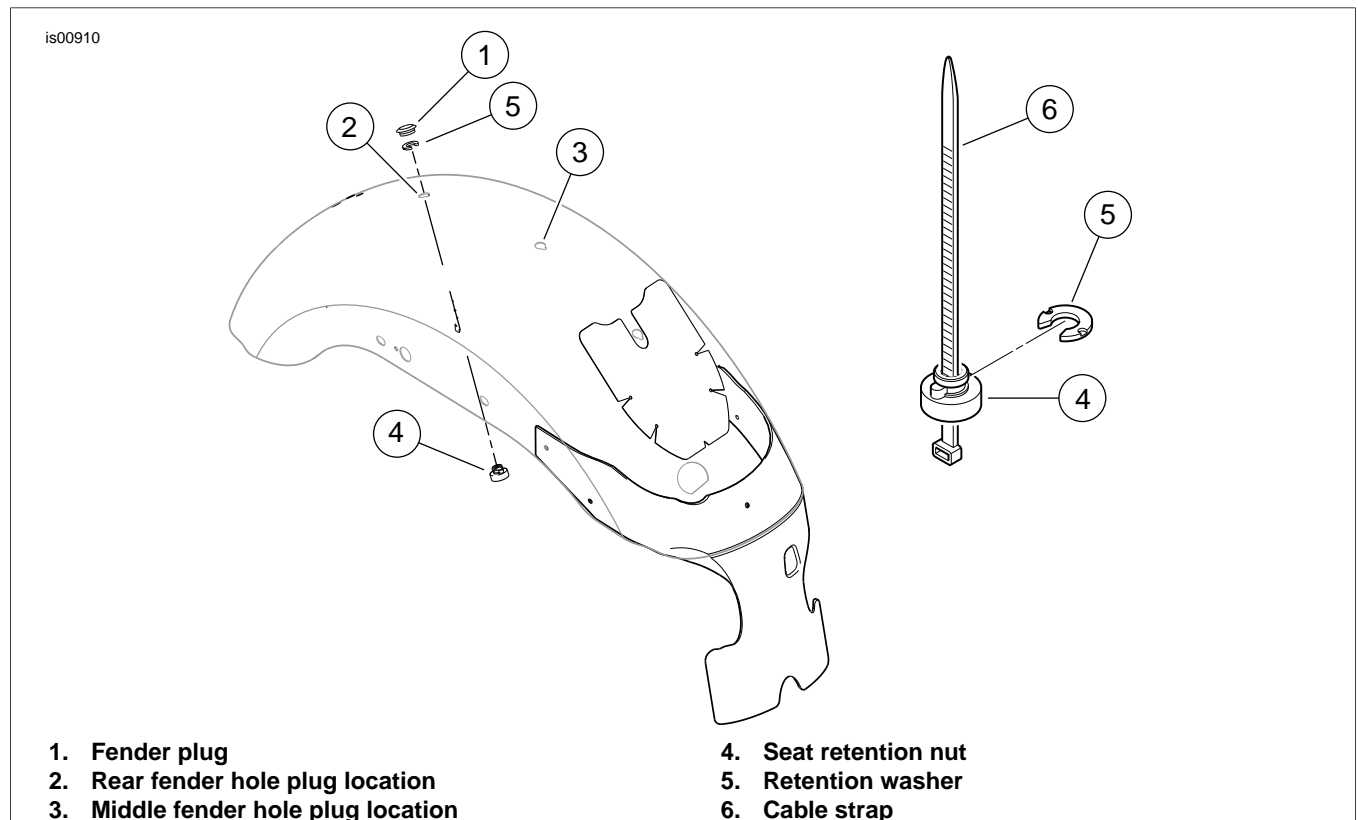

Figure 1. Fender Hole Locations



Figure 2. Underside of 2-up seat

## INSTALLATION

### NOTE

If installing the seat with a sissybar/backrest pad present, remove the backrest pad prior to seat installation. This will prevent damage to the pad and/or seat. Install backrest pad after the seat is installed.

#### 1. Models equipped with solo seats:

**For XL883 and XL883L models:** see Figure 1.

- a. Remove the plastic plug (1) from the rear hole location in the fender (2). Save the plastic plug for installation.
- b. Move the seat retention nut (4) and lockwasher (5) from the middle location to the rear location, where the plug was just removed. As shown in the inset, a cable strap (6) can be used as an installation aid. Place the retention nut (5) over the cable strap so that the wide end of the nut rests on the eye of the cable strap. Thread the cable strap up under the fender, and through the fender hole. Pull up on the cable strap to hold the nut snug against the underside of the fender.
- c. With the rib of the retention nut (4) seated into the notch in the fender hole, slide the retention washer (5) into place from the rear. This will lock the retention nut in place.
- d. Install the plastic plug in the fender hole in the middle location.
- e. On XL1200N, XL883N and XL1200X models, remove screw in rearward fender hole and discard.

### NOTE

The foam cushioning of the seat needs to be compressed as the seat is slid forward to engage the post on the frame when the seat is dropped into place. When properly installed, the front tongue on the underside of the seat should fit snugly in the groove at the fuel tank rear mounting location and the keyhole on the underside of the seat will lock the seat to the post on the frame.

#### 2. All models:

See Figure 2.

- a. Angle the front of the new seat into place so the tongue (1) engages the slot at the rear fuel tank mounting location.
  - b. Push the seat forward and rotate the rear of the seat downward until the seat contacts the frame. Flex the seat slightly in the middle and slide the seat towards the rear so that the keyhole slot (2) on the seat bottom engages with the center seat post on the frame.
3. See Figure 3. Pull up on the center of the seat to verify that it is locked into place. (There will be a small amount of play, but the seat should only come up about a half an inch and then will be held firmly in place by the post on the underside of the seat.) If the seat is not firmly in place, repeat Step 2 until the seat is firmly in place. Reference the Owners Manual for further instruction on seat placement if needed.
  4. Install the seat mounting (4) screw, and fasten the seat mounting bracket (3) to the top of the rear fender.
  5. On XL1200N, XL883N and XL1200X models, place guide washer over rear seat mounting hole in fender before installing seat screw.
  6. Tighten the mounting bracket screw securely to the fender.

### WARNING

**After installing seat, pull upward on seat to be sure it is locked in position. While riding, a loose seat can shift causing loss of control, which could result in death or serious injury. (00070b)**

7. Pull up on the front and rear of the seat again to verify that it is properly secured.

# SERVICE PARTS

is06968

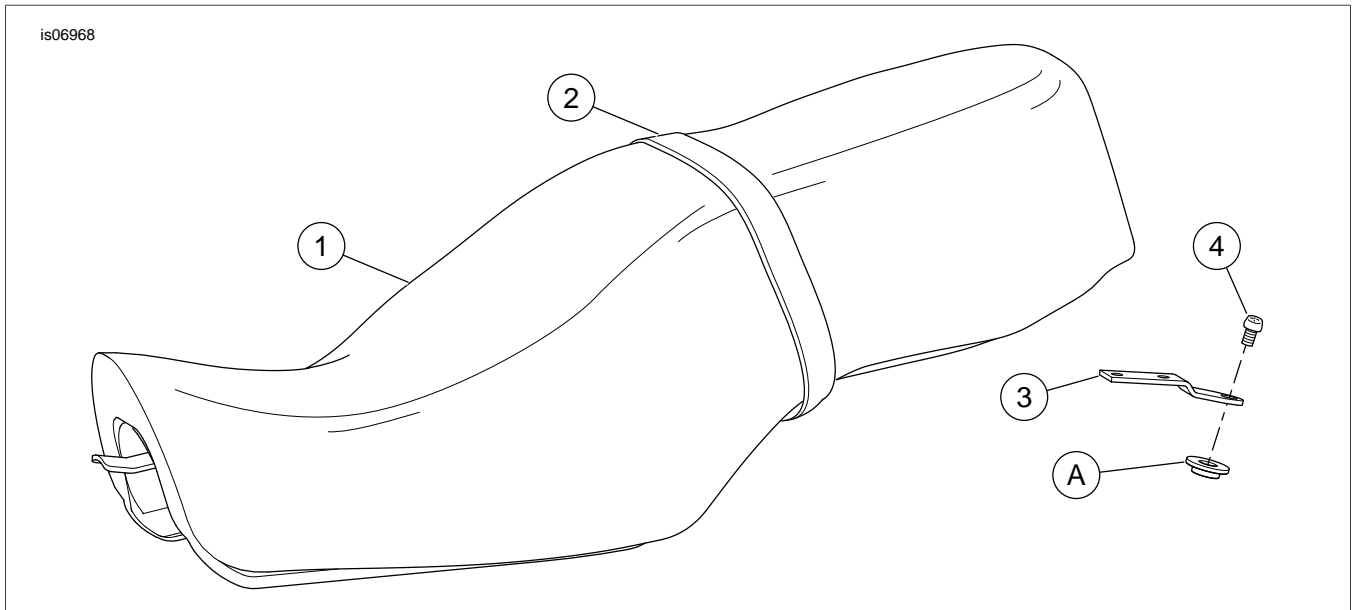

**Figure 3. Service Parts: XL Seat**

**Table 1. Service Parts Table**

Item	Description (Quantity)	Part Number	Item	Description (Quantity)	Part Number
1	Seat	Not sold separately	3	Mounting bracket	51652-97
2	Grabstrap		4	Seat mounting screw	Stock
	Kits 51736-07 and 51739-07	51508-04	<b>Items mentioned in text, but not included in kit:</b>		
	Kits 51747-07 and 51749-07	51184-00	A	Guide Washer (XL1200N, XL883N and XL1200X models only)	7487
	Kit 51737-07 and 51738-07	52293-04			
	Kit 52000024	52400008			