



# INSTRUCTIONS

-J04126

REV. 2006-07-11

## SPLIT VISION MIRROR KIT

### GENERAL

#### Kit Number

92190-06

#### Models

These kits are designed to fit all 1982 and later Harley-Davidson motorcycles.

#### Kit Contents

See Figure 1 and Table 1.

### INSTALLATION

1. Remove and discard the existing mirror. Discard any lockwashers and acorn nuts used to mount the original mirror.
2. **For motorcycles with turn signals mounted to the underside of the hand lever housings except 2004 and later XL models:** See Figure 1. Secure the left side mirror using only the flat washer (3) and the acorn nut (5) from the kit.
3. Secure the right side mirror with the flat washer (3) and acorn nut (5) from the kit and the turn signal retainer only. Do not use washer (4) on either side.  
For 2004 and later XL models use only the lockwasher (4), and acorn nut (5) on each side.
4. **For motorcycles with turn signals mounted away from the hand lever housings:** Insert the mirror studs into the holes in the hand lever housings, and secure the mirrors with the flat washers (3), lockwashers (4) and acorn nuts (5) from the kit.
5. Adjust the mirrors for proper field of vision and tighten the acorn nut to 12 ft-lbs (16 Nm). Check mirror adjustment and reposition if necessary.

### SERVICE PARTS

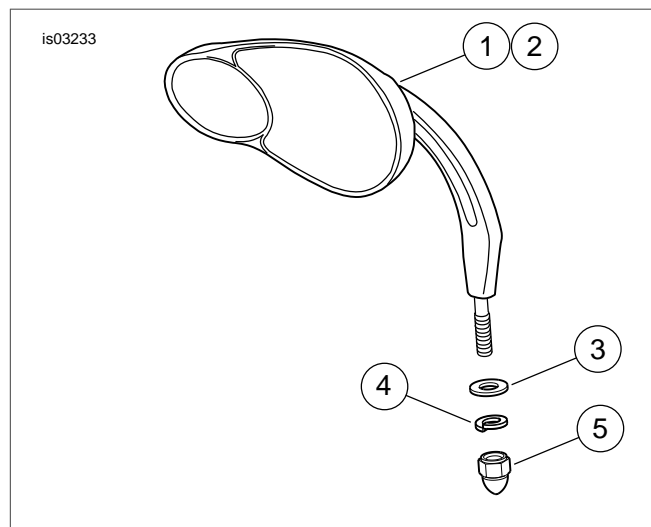

Figure 1. Service Parts: Split Vision Mirror

Table 1. Service Parts Table

Item	Description (Quantity)	Part Number
1	Mirror, right side	92191-06
2	Mirror, left side	92198-06
3	Washer, flat, 11/16" O.D. (2)	6771A
4	Lockwasher, 5/16" (2)	7041
5	Acorn nut, 5/16-24, (2)	7736

#### NOTE

Harley-Davidson Motor Company cannot test, and make specific fitment recommendations concerning every possible mirror, and handlebar combination. Therefore, after installing new mirrors, or handlebars, and before operating the motorcycle, check to ensure that the mirrors provide the operator a clear view to the rear.