



# INSTRUCTIONS

-J03677

REV. 2005-09-16

## AUXILIARY BRAKE/ RUN/TURN SIGNAL CONVERSION KIT

### GENERAL

#### Kit Number

69463-06

#### Models

This kit is designed for installation on 2004 and later XL (Sportster®) model motorcycles.

### WARNING

The rider's safety depends upon the correct installation of this kit. Use the appropriate service manual procedures. If the procedure is not within your capabilities or you do not have the correct tools, have a Harley-Davidson dealer perform the installation. Improper installation of this kit could result in death or serious injury. (00333a)

#### NOTE

This instruction sheet references Service Manual information. A Service Manual for your model motorcycle is required for this installation and is available from a Harley-Davidson Dealer.

#### Kit Contents

See Figure 3 and Table 1.

### WARNING

When installing any electrical accessory, be certain not to exceed the maximum amperage rating of the fuse or circuit breaker protecting the affected circuit being modified. Exceeding the maximum amperage can lead to electrical failures, which could result in death or serious injury. (00310a)

#### NOTE

Red turn signal lenses may not be legal in all states. Check your local regulations.

#### NOTE

This kit requires up to 4.5 amps additional current from the brake light circuit while brakes are applied.

### CAUTION

It is possible to overload your motorcycle's charging system by adding too many electrical accessories. If your combined electrical accessories operating at any one time consume more electrical current than your vehicle's charging system can produce, the electrical consumption can discharge the battery and cause vehicle electrical system damage. See a Harley-Davidson dealer for advice about the amount of current consumed by additional electrical accessories, or for necessary wiring changes. (00211b)

### INSTALLATION

1. Following instructions in Service Manual, remove seat.
2. On the left side side of the bike, remove the side cover.

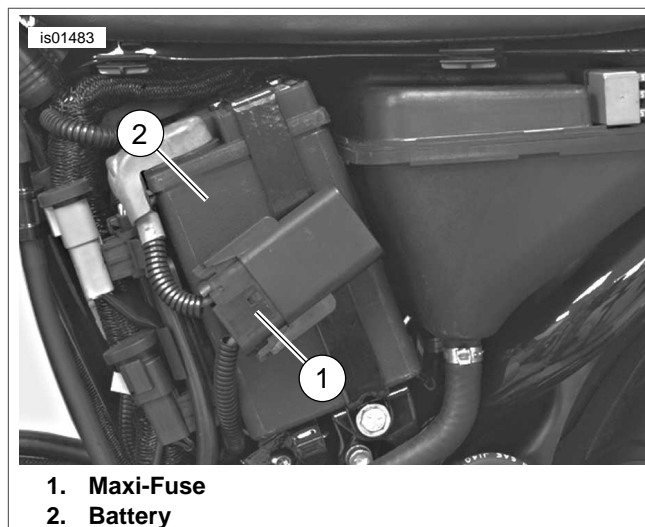
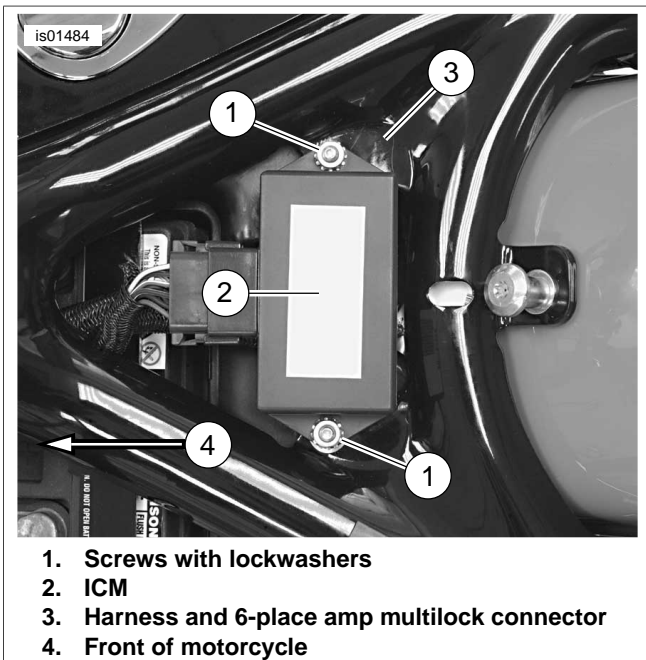

Figure 1. Disconnect Maxi-Fuse

3. See Figure 1. Locate and disconnect the Maxi-Fuse (1).
4. See Figure 2. Remove the two screws and lockwashers (1) securing the ICM module (2) to the frame. Save hardware for installation.



**Figure 2. 6-Place Amp Multilock Connector**

5. Next to the ICM module is a 6-place Amp Multilock connector (3) joining a wiring harness coming up from under frame just behind fuel tank and continuing toward the rear fender.
6. Disconnect the 6-place male from female harness connectors.
7. See Service Parts illustration. Obtain the turn signal module (3) from the kit and mate the 6-place Multilock module connectors to the corresponding male and female harness connections. Snap connectors into place.

**NOTE**

*Due to the very limited space underneath the seat, there is no single best location to secure the module. You will need to work the module into existing open space. When positioning the module, make sure that the connectors and module will*

*not be bound, and that the wiring will not be pinched when the seat is re-installed.*

8. Using the cable straps (2) from the kit, secure the module, connector and wiring to the frame or to other harnesses in area under seat.
9. Install the ICM unit using the lockwashers and nuts. Tighten securely.
10. Locate the notch in the original amber turn signal lens and insert a coin or a flat-blade screwdriver into the notch. Carefully twist the coin or screwdriver until the lens pops out of the rear turn signal housing.  
Repeat for the other rear turn signal lens.
11. Obtain the red turn signal lenses (1) from the kit. Snap a red lens into the turn signal housing. Repeat for the other lens.
12. Reinstall the Maxi-Fuse and the left side cover.

**WARNING**

**Be sure that all lights and switches operate properly before operating motorcycle. Low visibility of rider can result in death or serious injury. (00316a)**

13. Start the motorcycle and make sure that both left and right turn signals function properly, and that both rear turn signal lamps illuminate along with the original stop lamp when brakes are applied.
14. Following instructions in Service Manual, install the seat.

**WARNING**

**After installing seat, pull upward on seat to be sure it is locked in position. While riding, a loose seat can shift causing loss of control, which could result in death or serious injury. (00070b)**

**SERVICE PARTS**

See Figure 3 and Table 1.

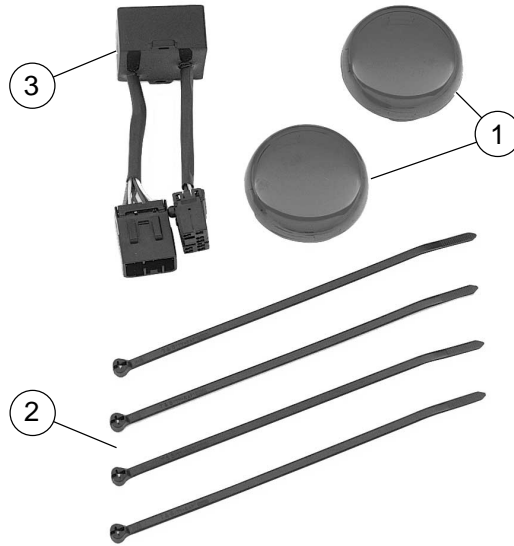

Figure 3. Service Parts: Turn Signal Module Kit

Table 1. Service Parts Table

Item	Description (Quantity)	Part Number
1	Lens, red (2)	68217-00
2	Strap, cable (4)	10006
3	Tail light/Turn signal module	69468-06