



INSTRUCTIONS

-J02486

REV. 2005-09-07

AILERON HAND GRIPS

GENERAL

Kit Number

56425-02

Models

This kit fits all 1996 and later model Harley-Davidson® motorcycles.

Additional Parts Required

Removal and re-installation of the right-side handlebar switch housing requires a Service Manual for your model and year of motorcycle. A Service Manual can be purchased from a Harley-Davidson Dealer.

Kit Contents

Table 1. Kit Contents

Description (Quantity)	Part Number
Hand grip, Aileron (left)	56231-03
Hand grip, Aileron (right)	56233-03

LEFT GRIP REMOVAL AND INSTALLATION

1. See Figure 1. Using a T27 TORX® drive head, remove the two screws with flat washers securing the handlebar clamp (3) to the clutch lever bracket. Remove the clamp, and position the clutch hand lever assembly away from the handlebar.
2. Using a T25 TORX drive head, loosen but do not remove the upper and lower switch housing screws (1).
3. Remove the end cap from the existing left hand grip if so equipped.

With "glueless" grip: Remove the grip from the handlebar.

With glued grip: Remove the grip by carefully cutting it away from the handlebar using a sharp blade or knife.

NOTE

Make sure that the handlebar surface and the inside of the **new** grip are smooth, dry and thoroughly cleaned of all dirt or adhesive residue.

WARNING

Do not lubricate left handlebar grip before installation. Lubricating grip can cause it to come off while riding, which could result in loss of control and death or serious injury. (00315a)

4. Position the new left grip (4) so the larger diameter portion of the flange (5) is at the bottom. Push the grip fully onto the handlebar.
5. Fit the grooves (2) on the outboard side of the upper and lower switch housing over the flanges on the end of the grip, then loosely fasten the two screws.
6. Position the clutch hand lever assembly inboard of the switch housing assembly, engaging the tab on the lower switch housing in the groove at the bottom of the clutch lever bracket.
7. Align the holes in the handlebar clamp with those in the clutch lever bracket, and loosely fasten the two screws with flat washers. Adjust the switch housing and clutch hand control position for rider comfort.
8. Using a T27 TORX drive head, tighten first the upper, then the lower handlebar clamp screws to 60-80 **in-lbs** (6.8-9.0 Nm).
9. Using a T25 TORX drive head, tighten first the lower, then the upper switch housing screws to 35-45 **in-lbs** (4.0-5.1 Nm).

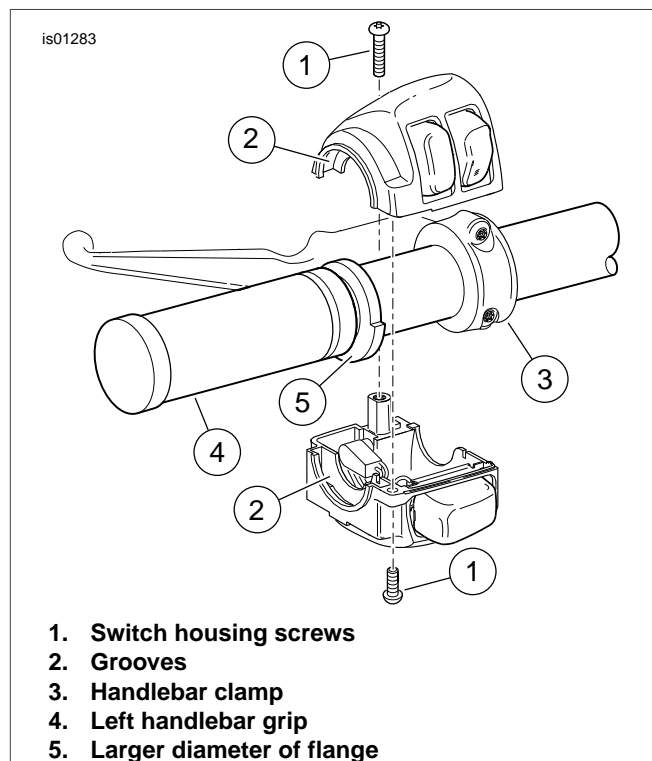

Figure 1. Left Handlebar Switch Housing

RIGHT GRIP REMOVAL AND INSTALLATION

WARNING

The rider's safety depends upon the correct installation of this kit. Use the appropriate service manual procedures. If the procedure is not within your capabilities or you do not have the correct tools, have a Harley-Davidson dealer perform the installation. Improper installation of this kit could result in death or serious injury. (00333a)

NOTE

Right handlebar switch housing removal and re-installation references Service Manual information. A Service Manual for your model and year of motorcycle is required for this procedure and is available from a Harley-Davidson Dealer.

1. Refer to the RIGHT HANDLEBAR SWITCH section of the Service Manual for removal of the switch housing assembly. This is necessary to access the throttle cables.

2. Refer to the THROTTLE CONTROL section of the Service Manual to disconnect the throttle cables and remove the existing right grip/ throttle sleeve assembly.

After removal, make sure that the handlebar surface and the inside of the **new** grip are smooth, dry and thoroughly clean.

3. Follow the instructions in the Service Manual to install the new right grip/ throttle sleeve to the handlebar and re-connect the throttle cables.

WARNING

Before starting engine, be sure throttle control will snap back to idle position when released. A throttle control that prevents engine from automatically returning to idle can lead to loss of control, which could result in death or serious injury. (00390a)

4. Verify that the right grip/ throttle sleeve rotates and returns freely and does not bind on the handlebar or switch housing.